

- Mount the DDIN radio to the supplied DDIN brackets using ISO screws. Connect all required circuit points. Re-connect negative battery terminal and test the unit for proper operation

Mount the radio into the dash opening.

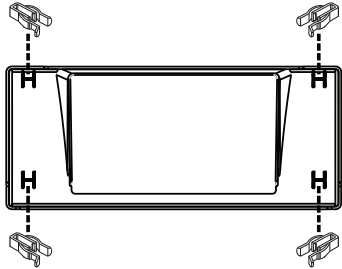

- Push the included snaps onto the legs of the DDIN Radio trim plate.



- Snap the DDIN trim plate over the radio. Reassemble dash in reverse order of disassembly.



Installation Manual Double DIN Kit

colour: black

381023-10

• BMW 5 (E39) series 1997-2003

Compatible with these double DIN devices

Double-DIN Navigation

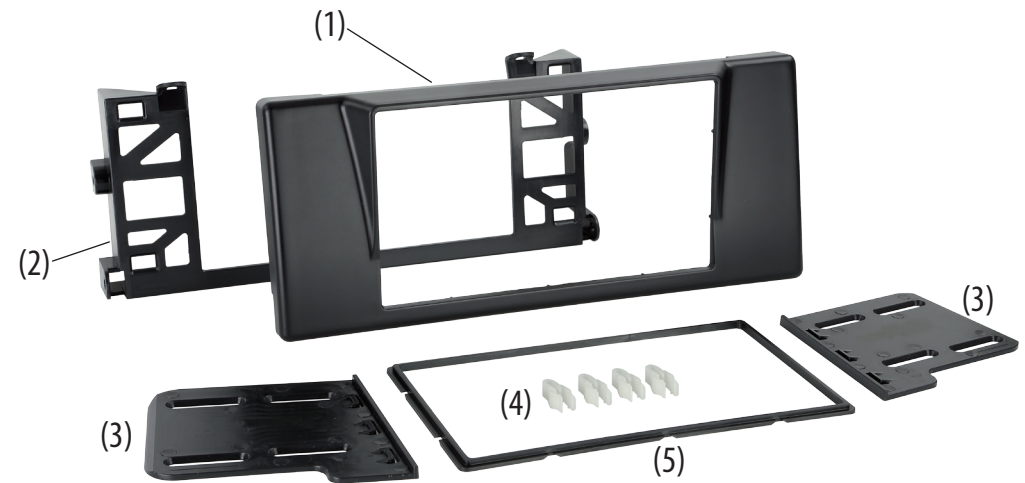

- (1) Double-DIN fascia plate
- (2) Mounting Frame
- (3) Mounting Brackets (left/right)
- (4) Panel Clamps (4x)
- (5) Trim Frame

All installation work must be performed by a qualified professional installer only.
The manufacturer / dealer is not liable for any kind of incidental or indirect damages.
© 09/2014 ALL RIGHTS RESERVED. Technical changes possible. No liability for misprints.

All installation work must be performed by a qualified professional installer only.
The manufacturer / dealer is not liable for any kind of incidental or indirect damages.

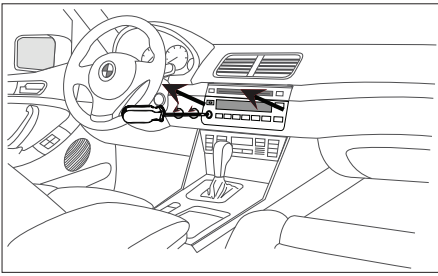

1. Remove the volume by pulling out towards the rear of the vehicle. Using a T-10 Torx screwdriver to turn the release screw 90° behind the volume knob then pull out on the bottom of the radio and remove

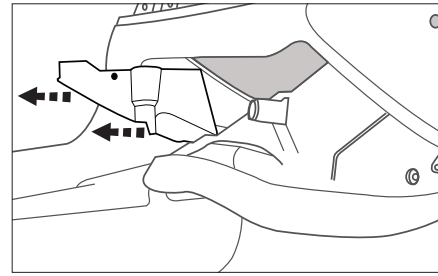

6. Remove (2) Phillips screws securing the panel on the inside left hand side of the glove box then remove the panel.

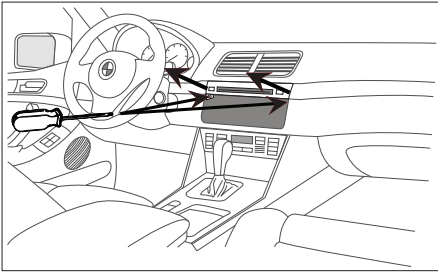

2. Disconnect the wiring. Remove (2) T-10 Torx screws securing the top of the factory radio then unclip and remove.

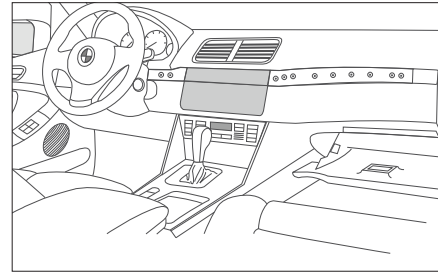

7. Remove the Phillips screws securing the glove box to the lower dash panel and let it hang.

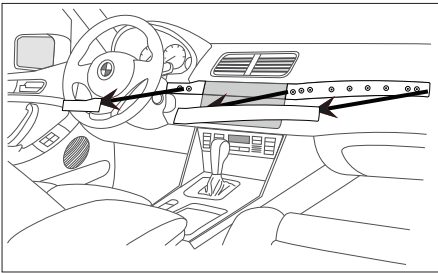

3. Disconnect the wiring. Unclip and remove the wood trim above the glove box and to the left

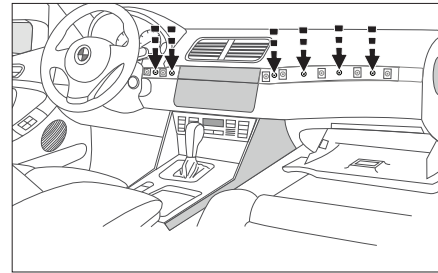

8. Remove the Phillips screws above the glove box and the one behind the cover on the side of the lower dash panel. Remove the two screws on the lower dash panel to the left of the radio.

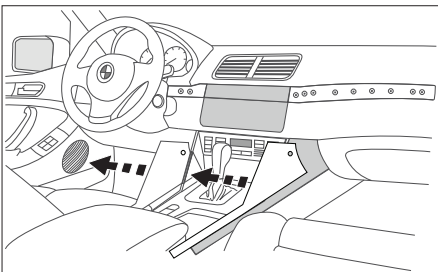

4. Remove the Phillips screws securing the (2) side panels on the center console then slide the panels forward to unclip and remove them.

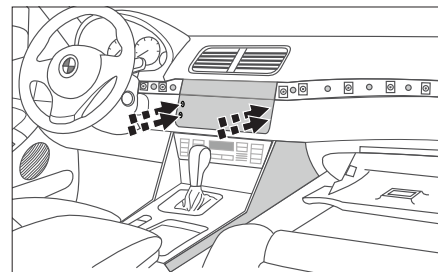

9. Remove the (4) Phillips screws securing the radio sub dash panel to the lower dash panel. Pull the right side of the lower dash panel outward to gain access to and remove the radio sub dash panel.

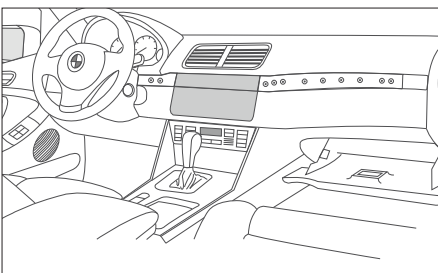

5. Unclip and remove the (2) glove box side supports with the glove box open.

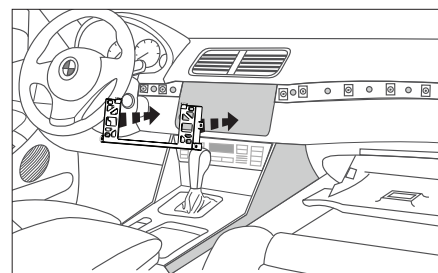

10. Mount the DDIN housing into the radio cavity using PPH-12 Phillips screws and (2) factory screws removed in disassembly.