

### "2-DIN" NAVIGATOR MOUNTING KIT - 7" MONITOR

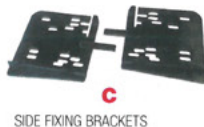

#### IMPORTANT TO KNOW THAT:

For navigators with depths exceeding 150 mm it is essential to remove a small interference (See Picture).

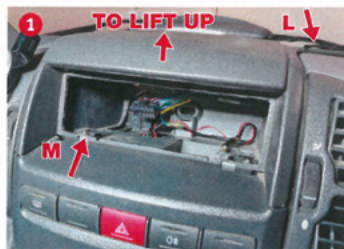

**1.** Remove the car radio, recover the two front screws **M** and the two rear screws **L** then remove the original panel.



**2.** Place the "base bracket **B**" using the two screws original **M**.

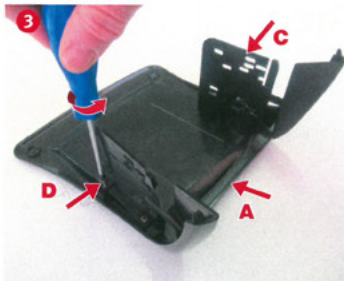

**3.** To install the navigator, it is necessary to place the "Navigator panel **A**" **UPSIDE DOWN** (on a suitable clean surface) and position the "side brackets **C**" (right and left) with the screws self-tapping **D** (or **D** with washers **F**) supplied without locking them.

**4.** Place the navigator **UPSIDE DOWN** on the two ribs **N**, push it towards the front of the panel into position desired by making it protrude at least 5 mm, then fix it on the brackets **C** with screws **E** (or **D** with washers **F**) supplied.

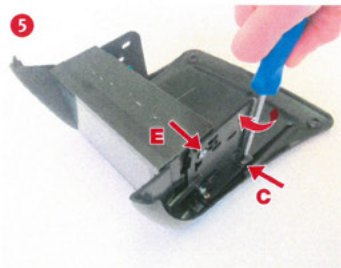
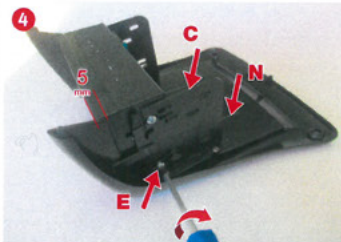

**5.** Finally tighten the screws **E** (at least 2 per side) and lock the brackets **C** on the fascia panel.

**6.** Turn the assembly (panel with navigator) and after making the necessary connections, position it from above on the vehicle by inserting the reference pins in their seats exerting a moderate pressure downwards to hook it to the "CLIPS" of the base bracket **B** previously mounted at "Point 2" and with the original screws **L** fix it to the rear of the vehicle.

